

ULTRA MINIATURE CERAMIC PACKAGE HIGH STABILITY SMD CRYSTAL

ABM3X



RoHS
Compliant



5.0 x 3.2 x 0.9mm

FEATURES:

- -40°C to +125°C wide operating temperature range
- ± 40 ppm Max. All Inclusive frequency stability over 10-year product life
- Fundamental Mode, low ESR Quartz design
- Ultra miniature, Seam-Sealed, RoHS compliant reflow-able package

APPLICATIONS:

- Zigbee based designs for indoor / outdoor applications
- Wireless Sensor Networks
- Industrial Control
- Home and Building Automation
- Consumer Electronics
- PC Peripherals

STANDARD SPECIFICATIONS

| Parameters | Minimum | Typical | Maximum | Units | Notes |
|---|-------------|------------------|---------|------------|------------------------|
| Center Frequency | ---- | 24.000 32.000 | ---- | MHz | |
| Operation Mode | Fundamental | | | | |
| Operating Temperature | -40 | ---- | +125 | °C | |
| Storage Temperature | -55 | ---- | +155 | °C | |
| Overall Frequency Stability (All inclusive) | -40 | ---- | +40 | ppm | |
| Frequency Tolerance | -10 | ---- | +10 | ppm | |
| Frequency Stability over the Operating Temperature Range (ref. to +25°C) | -25 | ---- | +25 | ppm | |
| Aging | -5 | ---- | +5 | ppm | @25 \pm 3°C 10 years |
| Equivalent series resistance (R1) | ---- | ---- | 30 | Ω | |
| Shunt capacitance (C0) | ---- | ---- | 3.5 | pF | |
| Motional capacitance (C1) | ---- | 4.5 | ---- | fF | |
| Load capacitance (CL) | ---- | 10 | ---- | pF | |
| Drive Level | 50 | ---- | 100 | μ W | |
| Insulation Resistance | 500 | ---- | ---- | M Ω | @100Vdc \pm 15V |

OUTLINE DIMENSIONS:

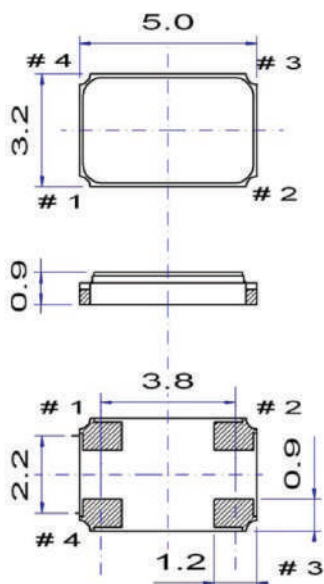

Pin function

- # 1 crystal connection
- # 2 GND
- # 3 crystal connection
- # 4 GND

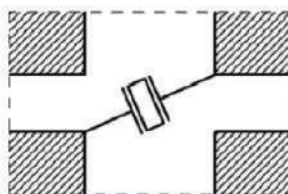

Do not design any conductive path between the pattern

Example for solder pattern

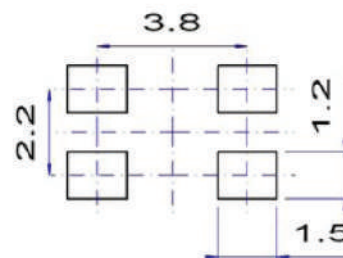

Dimensions: mm



ULTRA MINIATURE CERAMIC PACKAGE HIGH STABILITY SMD CRYSTAL

ABM3X

5.0 x 3.2 x 0.9mm

ABM3X



RoHS
Compliant

TAPE & REEL:

1000pcs/reel

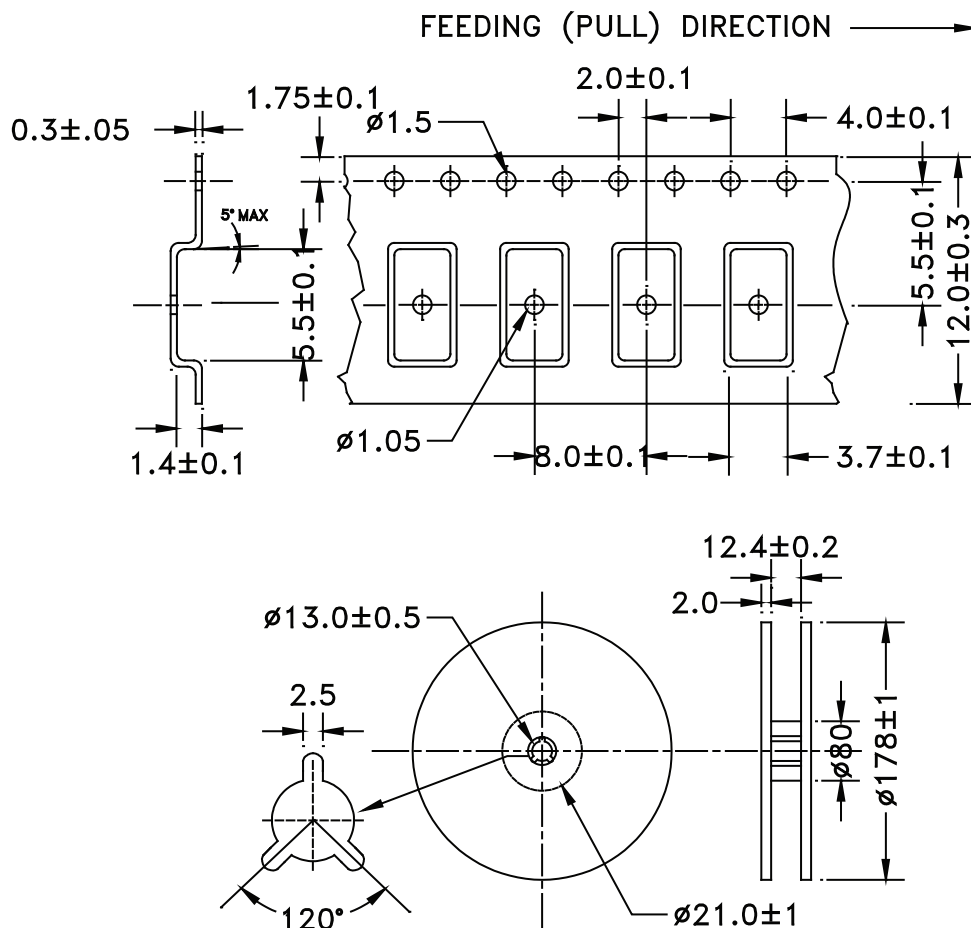

Dimensions: mm

REFLOW PROFILE:

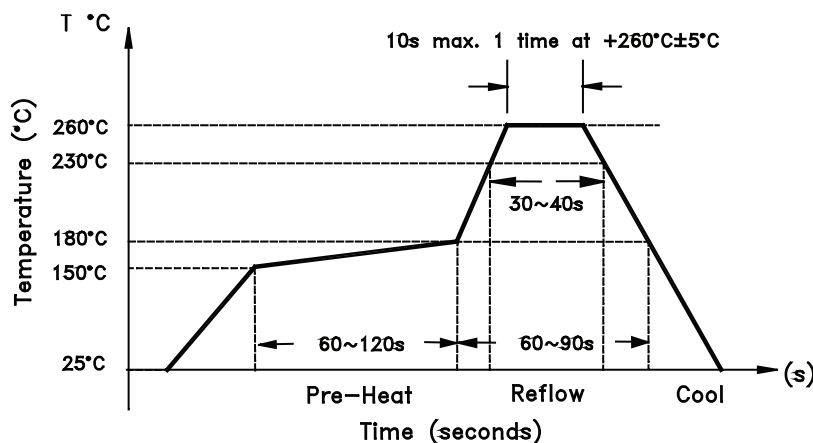

Need a test socket for the ABM3X Series? To view compatible **PRECISION TEST & BURN-IN SOCKETS** for these parts, [click here](#). P/N **AXS-5032-04-07**

ATTENTION: Abracon Corporation's products are COTS – Commercial-Off-The-Shelf products; suitable for Commercial, Industrial and, where designated, Automotive Applications. Abracon's products are not specifically designed for Military, Aviation, Aerospace, Life-dependant Medical applications or any application requiring high reliability where component failure could result in loss of life and/or property. For applications requiring high reliability and/or presenting an extreme operating environment, written consent and authorization from Abracon Corporation is required. Please contact Abracon Corporation for more information.

ABRACON IS
ISO9001:2008
CERTIFIED

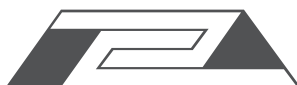

ABRACON
CORPORATION

Visit www.abracon.com for Terms & Conditions of Sale **Revised: 03.30.11**
30332 Esperanza, Rancho Santa Margarita, California 92688
tel 949-546-8000 | fax 949-546-8001 | www.abracon.com